



PROFESSIONAL  
OUTDOOR LIGHTING

Type:

Model:

Project:

## SPECIFICATION SHEET

### MODEL 2118 Landscape Series • Brass & Copper • Specialty Lights

#### FIXTURE SPECIFICATIONS:

**HOUSING:**

CNC machined solid brass or stainless steel bar stock.

**FINISH:**

Natural brass or stainless steel.

**LENS:**

Convex frosted lens or clear

**LAMP TYPE:**

5W LC5ND - LED Group C

**MOUNTING:**

Internally weighted for stable placement underwater.

**FASTENERS:**

All fasteners are stainless steel.

**WIRING:**

Pre-wired with a fifteen-foot pigtail of 18-2 double jacketed, water-resistant cable. Connectors for a required above-water connection are also included.

All Vista luminaires are **MADE IN U.S.A.**

**Caution:** Follow installation instructions as well as local electrical codes when installing underwater fixtures. Underwater fixtures are NOT for use in swimming pools or spas.

#### DIMENSIONS:

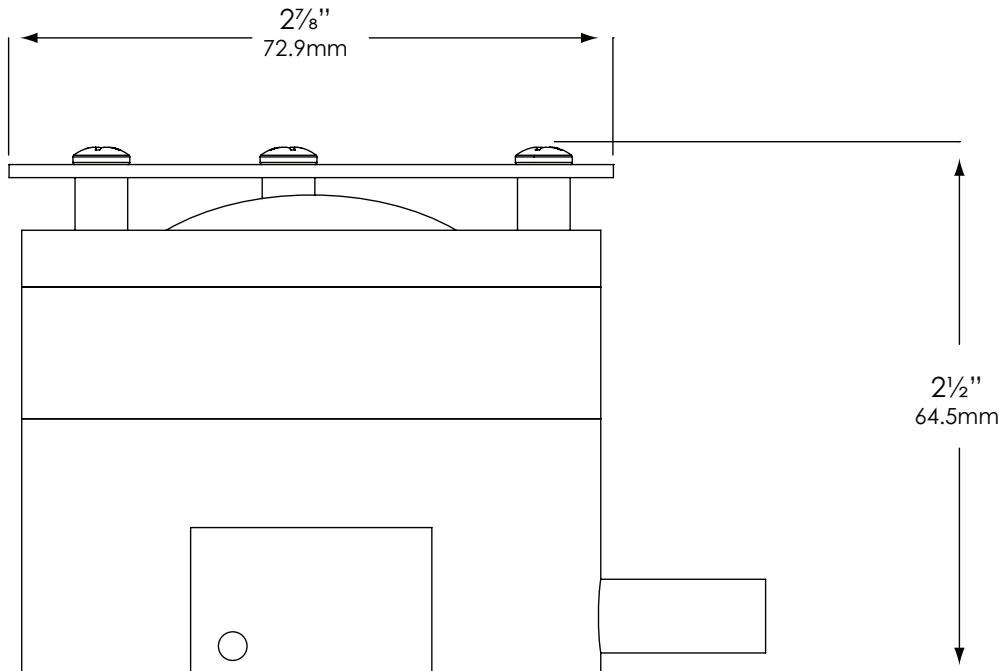

Vista Professional Outdoor Lighting reserves the right to modify the design and/or construction of the fixture shown without further notification.



# SPECIFICATION SHEET

---

## MODEL 2118 Landscape Series • Brass & Copper • Specialty Lights

### FIXTURE ORDERING INFORMATION

TO ORDER FIXTURE: Select appropriate choice from each column as in the following example.

**EXAMPLE: UW-2118-BSN-LC5ND**

MOUNTING	MODEL	FINISH	LAMP
UW - Underwater	2118	BSN - Natural Brass SS - Stainless Steel	LED - Group C 5W LC5ND - LED Group C Emitter Qty - 1 Temperature - Neutral (N), Warm (W), Cool (C) Operating voltage range - 6 to 15V.

Note: Underwater fixtures NOT for use in swimming pools or spas.